

Tempo



Respect

TEM14602AH | 2 beds | 2 baths | 790 sq. ft.

 Alternate Door Location Available

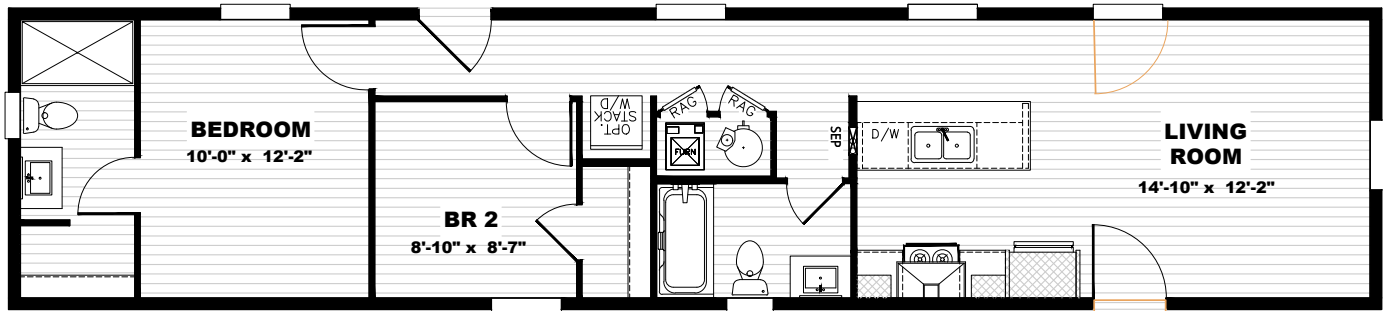

- Full Drywall Throughout
- DuraCraft® Cabinets
- Frigidaire® Stainless Steel Appliance Package
- Craftsman Style Front Door
- Ecobee® Smart Thermostat
- Carrier® Furnace



[View This Plan Online](#)



The home series and floor plans indicated will vary by retailer and state. Your local Home Center can quote you on specific prices and terms of purchase for specific homes. Clayton West invests in continuous product and process improvement. All home series, floor plans, specifications, dimension, features, materials, availability, and starting prices shown on this website are artist's renderings or estimates, and are subject to change without notice. Dimensions are nominal and length and width measurements are from exterior wall to exterior wall.



Tempo Specs

Revised Standard Features, April 2023

- 8' Flat Ceilings
- Tape & Texture Throughout
- 2x4" Exterior Walls
- DuraCraft® Cabinets
Feat. 42" Overheads
- LED Recessed Can Lights Throughout
- Ceiling Fan Prep in Living Room and Master Bedroom
- Fiberglass Tubs and Showers
- Frigidaire® Stainless Steel Appliance Package
Feat. 18' Top Freezer
- Pfister® Faucets Throughout
Feat. Brushed Nickel Pull Down In Kitchen
- 36" Stainless Steel European Range Hood
- Congoleum® Lux Linoleum
- Kwikset® Door Hardware Throughout
Feat. Thumbblatch Front Door
- Craftsman Style Front Door, 9 Lite Rear Door
- 30 yr Architectural Shingles
- Awning Ready Option for Communities
- Energy Star® Ready (R-22 floor, R-11 wall, R-33 roof)
- WUI (CA Wildfire) Option
- Garbage Disposal Option
- ecobee® Smart Thermostat
- Carrier® Furnace
- 2" Pre-Installed Window Blinds
- 2"x6" Wall - Climate Package
- Upgrade Roof Load Options



The home series and floor plans indicated will vary by retailer and state. Your local Home Center can quote you on specific prices and terms of purchase for specific homes. Clayton West invests in continuous product and process improvement. All home series, floor plans, specifications, dimension, features, materials, availability, and starting prices shown on this website are artist's renderings or estimates, and are subject to change without notice. Dimensions are nominal and length and width measurements are from exterior wall to exterior wall.



Tempo Specs

EXTERIOR OPTIONS



Early Evening
with Cool
Charcoal Accent

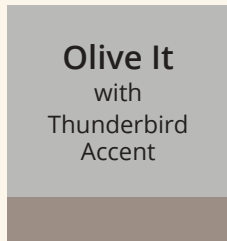

Olive It
with
Thunderbird
Accent

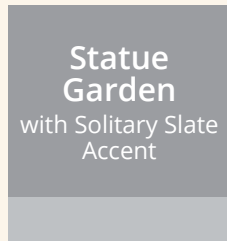

Statue Garden
with Solitary Slate
Accent



Light Drizzle
with Oatmeal
Accent

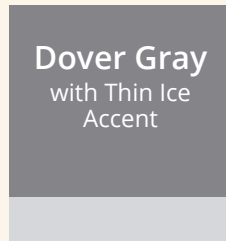

Dover Gray
with Thin Ice
Accent



Gray Heron
with Oatmeal
Accent

INTERIOR OPTIONS

Bishop Oak Cabinet Package



Bishop Oak Picture Frame
Duracraft Cabinets
Primary Kitchen and
Bathroom Cabinets



Plover Picture Frame
Duracraft Cabinets
Kitchen Island Cabinets

Studio Beige Cabinet Package



Studio Beige Picture Frame
Duracraft Cabinets
Primary Kitchen and
Bathroom Cabinets



Onyx Picture Frame
Duracraft Cabinets
Kitchen Island Cabinets

Countertops

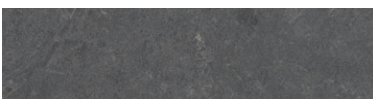

Terrena Soapstone



Silver Quartzite

Flooring



Linoleum: LUX Natural Oak #311



Carpet: Shaw Weathered New Weave
Available only in multi-sections

Cabinet Knobs



L: Brushed Brass Egg Knob
R: Matte Black Round Knob



The home series and floor plans indicated will vary by retailer and state. Your local Home Center can quote you on specific prices and terms of purchase for specific homes. Clayton West invests in continuous product and process improvement. All home series, floor plans, specifications, dimension, features, materials, availability, and starting prices shown on this website are artist's renderings or estimates, and are subject to change without notice. Dimensions are nominal and length and width measurements are from exterior wall to exterior wall.

